

**ONE AND SIX YEAR PLAN
FOR
STREET IMPROVEMENTS**

FISCAL YEARS

2015 thru 2020

FOR

City of Milford

Prepared by:

Troy M. Johnston

City Street Superintendent S-1239

JEO Consulting Group, Inc.

**142 W. 11TH STREET, PO BOX 207
WAHOO, NEBRASKA 68066
(402) 443-4661; FAX (402) 443-3508**

OFFICES IN:

NEBRASKA AND IOWA

Board of Public Roads Classifications and Standards
Form 7 One- and Six-Year Plan
Highway or Street Improvement Project

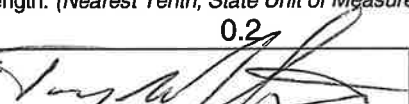
County:	City: Milford	Village:																
Location Description: Oak Avenue between Oak Circle West and F Street																		
Existing Surface Type and Structures: <i>(Such as dirt, gravel, asphalt, concrete, culvert, or bridge)</i> None																		
Average Daily Traffic: 2015 = 0, 2035 = 100		Classification Type: <i>(As shown on Functional Classification Map)</i> Local																
PROPOSED IMPROVEMENT																		
Design Standard Number: M	Surfacing	Thickness: 7" Width: 30'																
<input checked="" type="checkbox"/> Grading	<input checked="" type="checkbox"/> Concrete	<input checked="" type="checkbox"/> Right of Way																
<input type="checkbox"/> Aggregate	<input checked="" type="checkbox"/> Curb & Gutter	<input type="checkbox"/> Utility Adjustments																
<input type="checkbox"/> Armor Coat	<input checked="" type="checkbox"/> Drainage Structures	<input type="checkbox"/> Fencing																
<input type="checkbox"/> Asphalt	<input type="checkbox"/> Erosion Control	<input type="checkbox"/> Sidewalks																
<input type="checkbox"/> Lighting																	
<table border="1" style="width:100%; border-collapse: collapse;"> <tr> <td style="width:30%;">Bridge to Remain in Place</td> <td>Roadway Width:</td> <td>Length:</td> <td>Type:</td> </tr> <tr> <td>New Bridge</td> <td>Roadway Width:</td> <td>Length:</td> <td>Type:</td> </tr> <tr> <td>Box Culvert</td> <td>Span:</td> <td>Rise:</td> <td>Length:</td> </tr> <tr> <td>Culvert</td> <td>Diameter:</td> <td>Length:</td> <td>Type:</td> </tr> </table>			Bridge to Remain in Place	Roadway Width:	Length:	Type:	New Bridge	Roadway Width:	Length:	Type:	Box Culvert	Span:	Rise:	Length:	Culvert	Diameter:	Length:	Type:
Bridge to Remain in Place	Roadway Width:	Length:	Type:															
New Bridge	Roadway Width:	Length:	Type:															
Box Culvert	Span:	Rise:	Length:															
Culvert	Diameter:	Length:	Type:															
Bridges and Culverts Sized	<input type="checkbox"/> Yes <input type="checkbox"/> N/A	<input checked="" type="checkbox"/> Hydraulic Analysis Pending																
Other Construction Features: New road not yet platted																		
ESTIMATED COST <i>(in Thousands)</i>	★ COUNTY	★ CITY	★ STATE	★ FEDERAL	★ OTHER	TOTAL												
★ OPTIONAL		235				235												
Project Length: <i>(Nearest Tenth, State Unit of Measure)</i> 0.2			Project No.: M-422-(7)															
Signature: 		Title: Troy Johnston, St. Supt.		Date: 1/30/2015														

Board of Public Roads Classifications and Standards
Form 7 One- and Six-Year Plan
Highway or Street Improvement Project

County:	City: Milford	Village:
---------	----------------------	----------

Location Description:
Welch Park Road - 5th Street to 1st Street

Existing Surface Type and Structures: *(Such as dirt, gravel, asphalt, concrete, culvert, or bridge)*
Asphalt

Average Daily Traffic: 2015 = 100, 2035 = 250	Classification Type: <i>(As shown on Functional Classification Map)</i> Local
---	---

PROPOSED IMPROVEMENT

Design Standard Number: M	Surfacing	Thickness: 8"	Width: 30'
-------------------------------------	------------------	-------------------------	----------------------

<input checked="" type="checkbox"/> Grading	<input checked="" type="checkbox"/> Concrete	<input type="checkbox"/> Right of Way	<input type="checkbox"/> Lighting
<input type="checkbox"/> Aggregate	<input checked="" type="checkbox"/> Curb & Gutter	<input type="checkbox"/> Utility Adjustments	<input type="checkbox"/>
<input type="checkbox"/> Armor Coat	<input checked="" type="checkbox"/> Drainage Structures	<input type="checkbox"/> Fencing	<input type="checkbox"/>
<input type="checkbox"/> Asphalt	<input checked="" type="checkbox"/> Erosion Control	<input type="checkbox"/> Sidewalks	<input type="checkbox"/>

Bridge to Remain in Place	Roadway Width:	Length:	Type:
New Bridge	Roadway Width:	Length:	Type:
Box Culvert	Span:	Rise:	Length: Type:
Culvert	Diameter:	Length:	Type:

Bridges and Culverts Sized Yes N/A Hydraulic Analysis Pending

Other Construction Features:
Concrete Project

ESTIMATED COST <i>(in Thousands)</i>	★ COUNTY	★ CITY	★ STATE	★ FEDERAL	★ OTHER	TOTAL
★ OPTIONAL		380				380

Project Length: <i>(Nearest Tenth, State Unit of Measure)</i> 0.3	Project No.: M-422-(8)
---	----------------------------------

Signature:	Title: Troy Johnston, St. Supt.	Date: 1/30/2015
------------	---	---------------------------

Board of Public Roads Classifications and Standards
Form 7 One- and Six-Year Plan
Highway or Street Improvement Project

County:	City: Milford	Village:				
Location Description: Welch Park Road - 1st Street to North Corporate Limits						
Existing Surface Type and Structures: <i>(Such as dirt, gravel, asphalt, concrete, culvert, or bridge)</i> Asphalt						
Average Daily Traffic: 2015 = 100, 2035 = 250		Classification Type: <i>(As shown on Functional Classification Map)</i> Local				
PROPOSED IMPROVEMENT						
Design Standard Number: M	Surfacing	Thickness: 8" Width: 30'				
<input checked="" type="checkbox"/> Grading <input checked="" type="checkbox"/> Concrete <input type="checkbox"/> Right of Way <input type="checkbox"/> Lighting <input type="checkbox"/> Aggregate <input checked="" type="checkbox"/> Curb & Gutter <input type="checkbox"/> Utility Adjustments <input type="checkbox"/> <input type="checkbox"/> Armor Coat <input checked="" type="checkbox"/> Drainage Structures <input type="checkbox"/> Fencing <input type="checkbox"/> <input type="checkbox"/> Asphalt <input checked="" type="checkbox"/> Erosion Control <input type="checkbox"/> Sidewalks <input type="checkbox"/>						
Bridge to Remain in Place	Roadway Width:	Length: Type:				
New Bridge	Roadway Width:	Length: Type:				
Box Culvert	Span: Rise: Length:	Type:				
Culvert	Diameter:	Length: Type:				
Bridges and Culverts Sized	<input type="checkbox"/> Yes <input checked="" type="checkbox"/> N/A <input type="checkbox"/> Hydraulic Analysis Pending					
Other Construction Features: Concrete project						
ESTIMATED COST <i>(in Thousands)</i> ★ OPTIONAL	★ COUNTY	★ CITY 370	★ STATE	★ FEDERAL	★ OTHER	TOTAL 370
Project Length: <i>(Nearest Tenth, State Unit of Measure)</i> 0.3				Project No.: M-422-(9)		
Signature: 		Title: Troy Johnston, St. Supt.		Date: 1/30/2015		

MILFORD, NEBRASKA ONE AND SIX YEAR PLAN FISCAL YEAR 2015-2020

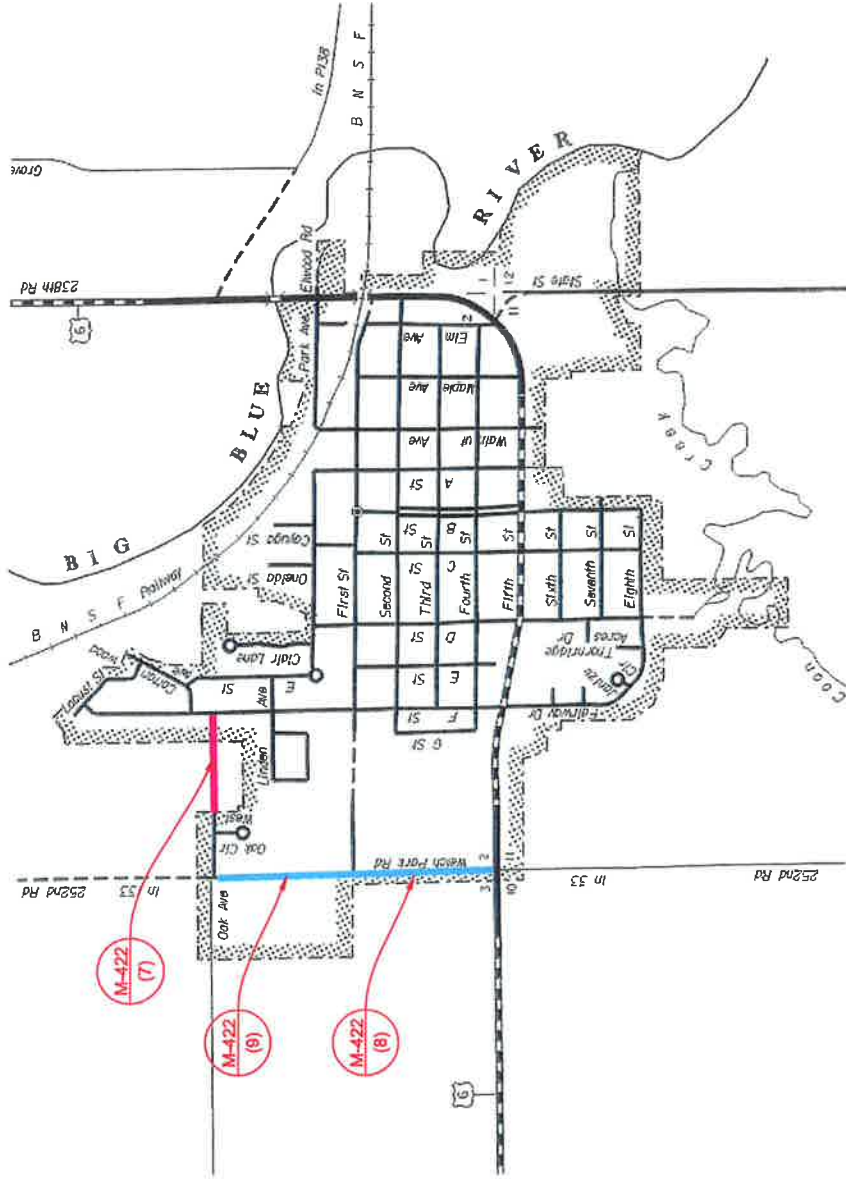

LEGEND

6 YEAR PLAN

6 YEAR PLAN

DRAWING NAME: 960933 1&6
REVISED BY: BPC
REVISED ON:

RESOLUTION

No. 516

The following resolution was introduced by Baker, who moved its adoption, seconded by Kral,

“WHEREAS, the City Street Superintendent has prepared and presented a One Year and Six Year Plan for Street Improvement Program for the City of Milford, and

WHEREAS, a public meeting was held on the 3rd day of March, 2015, to present this plan and there were no objections to said plan;

THEREFORE, BE IT RESOLVED BY THE Mayor and City Council of Milford, Nebraska, that the plans and data as furnished are hereby in all things accepted and adopted.”

Upon roll call vote as follows:

Baker yes

Kral yes

Fortune yes

Heckman yes

Dean A. Brubaker
Mayor

ATTEST:

Sharonne Haggard
Clerk

